

ANTENNA

The Antenna is a wireless communication interface.

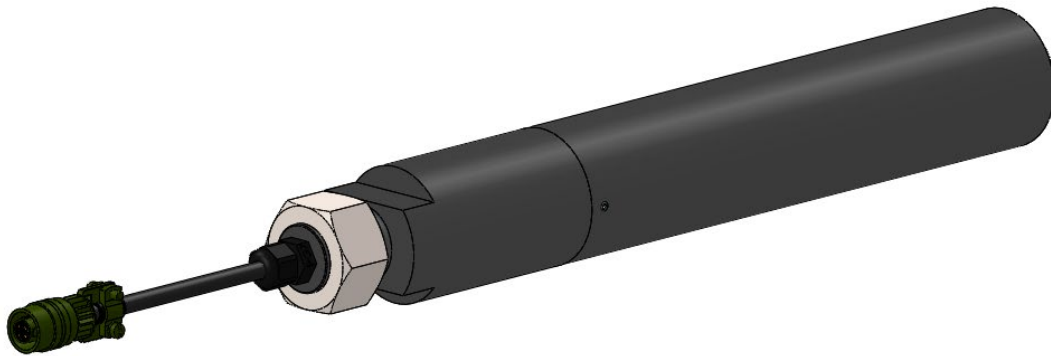

The Antenna is equipped with an RS-232 or RS-485 interface and a modem to provide wireless communication for SwiftGate and SwiftSign system.

- **MODEM**

The modem is designed for reliable transfer of digital data over distances of up to 4 miles (6.4km) line of sight. It implements a Frequency Hopping Spread Spectrum (FHSS) protocol. The module automatically handles all radio functions resulting in a UART-to-antenna wireless link. The frequency band is ISM (902 to 928 MHz) and the FCC ID is Q7V-3F090008X.

- **INTERFACE**

Available interfaces for the Antenna are RS-232 or RS-485.

